

ADVANCED INSTALLATION TIPS
- AND -
REMOVAL INSTRUCTIONS

*THESE STEPS ARE
NOT REQUIRED*

Table of Contents:

- Page 8 - Precise Alignment Installation Instructions.
- Page 10 - Trimming your Vinyl Decal (flush to the floor or floor trim installations only).
- Page 10 - Removing your Vinyl Decal

PRECISE ALIGNMENT - STEP 1:

Locate an area on your vinyl decal that can be used to help you create a straight horizontal line which you can use as a reference point to properly align it to the wall. Using a ruler or any long straight object draw a straight line across the surface of the application tape using a pencil or pen (*as shown in photo #26 and 27*).

Notice in photo #26 I used the protruding frame around the lower base of the grandfather clock vinyl decal (which likely is horizontally aligned) to draw this horizontal line.

Some vinyl decals may not have flat edges or horizontal objects in the vinyl decal to help you draw this line. In that case you will have to use your eyes to locate the best place for this horizontal line. Most vinyl decals that you have to "eye-ball align" will not look funny if they are slightly unaligned so don't be concerned if it's not perfect. These types of vinyl decals have no flat edges or horizontally aligned elements for your eyes to use for reference, thus there would be no way for the human eye to tell it's not aligned properly.

If you're attempting to use letters for alignment note that some letters such as "j," "g" or "y" fall below the baseline and the tails of these letters are not always uniformly horizontal.

Note that you'll be using the floor and ceiling to properly align your vinyl decal. If the floor and/or ceiling are not level/straight, then you can create your own straight edge (in the form of a line) by using a water soluble pencil to draw a straight line across the wall the vinyl decal will be applied to. It helps if this line extends past the vinyl decal's edges at each end or you may not see this line once you lay the vinyl decal on top of it. If you don't have a water soluble pencil to create this horizontal line then put a long piece of masking tape on the wall and draw this line using a pencil or a pen on the piece of tape instead of the wall.

Using small tabs of tape (masking tape or painter's tape will work best for this), tack the vinyl decal to the wall until you are satisfied with your placement (*as shown in photo #28*).

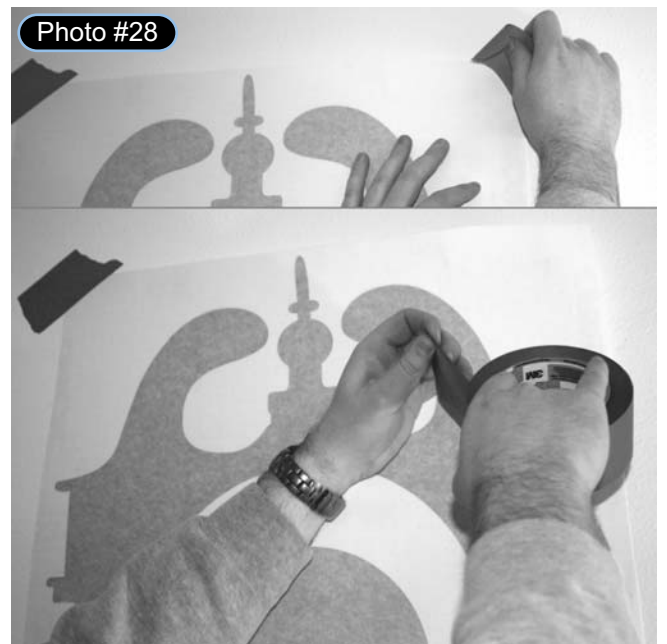
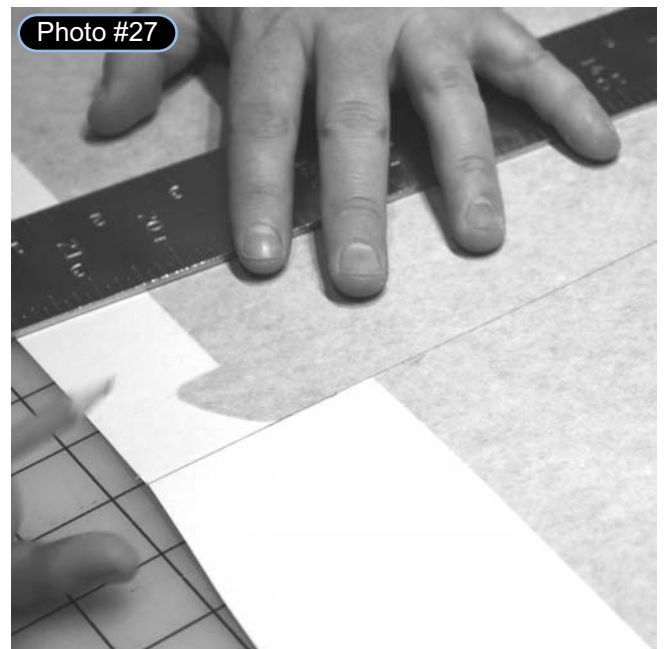

PRECISE ALIGNMENT - STEP 2:

Next, you should use the horizontal line you drew on the application tape for reference use a measuring tape to measure either from the ceiling or the floor on each end of the horizontal line (*as shown in photos #29 and #30*). If the measurements are different on each side then your vinyl decal is not straight. It's easy to move your decal into alignment if it's not straight. Simply remove one of the tabs of tape and adjust that side until it's close to the same measurement from your horizontal pencil line as the other side. Then quickly re-apply the tab of tape to keep it in place (*as shown in photo #31*). Now that your vinyl decal is in perfect alignment go ahead and skip back to the THIRD paragraph of "INSTALLATION - STEP 1" on page 3.

Photo #29



Photo #30

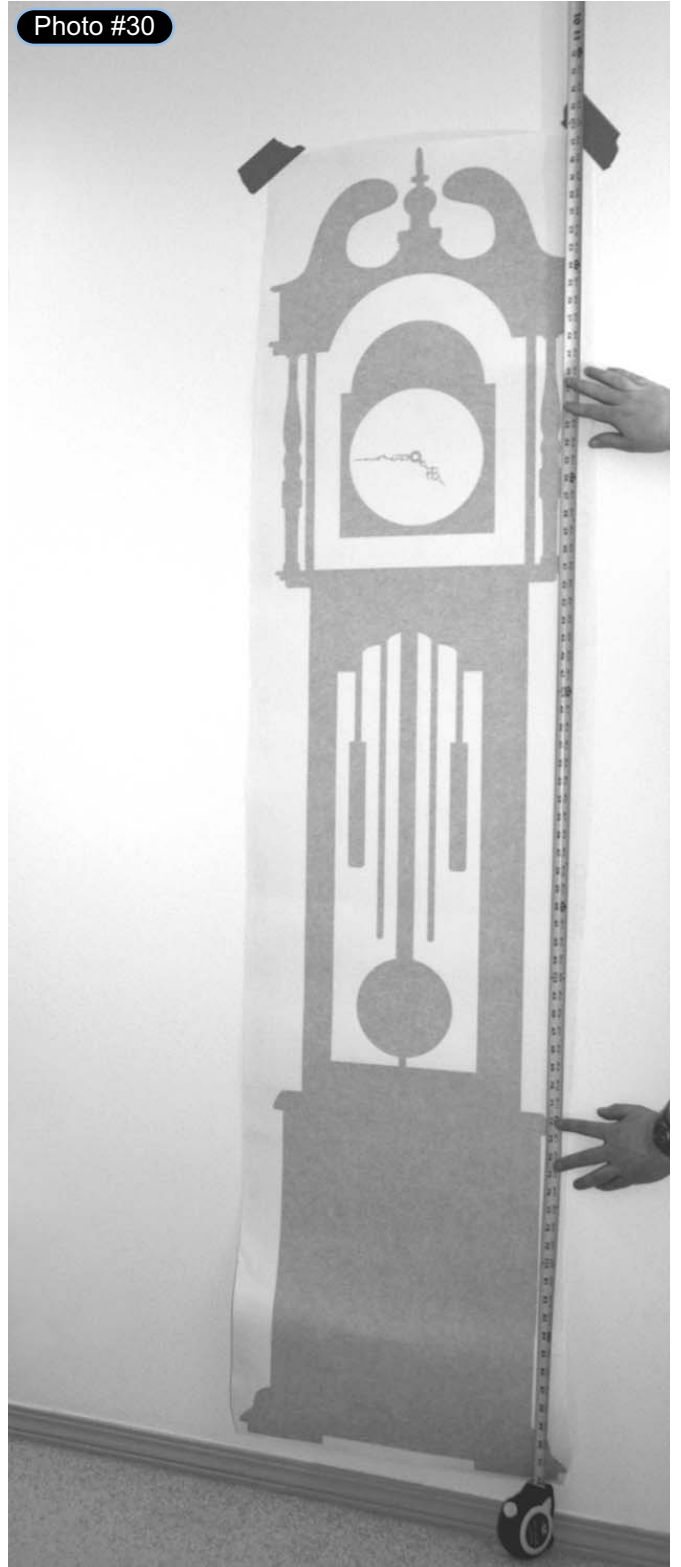

Photo #31



TRIMMING YOUR VINYL DECAL:

This step is only necessary if you want your vinyl decal flush with the floor or floor trim. If your vinyl decal goes all the way to the floor, some of it may need to be cut or trimmed away in order to make it flush with the floor or floor trim. Use a razor blade or very sharp knife to carefully trim or cut away the vinyl that's overlapping onto your floor or floor trim (*as shown in photos #32 and #33*). The overlapping area of your vinyl decal that has been trimmed or cut can be peeled away by hand to expose a new edge that should be flush with your floor or floor trim (*as shown in photo #34*).



Photo #32

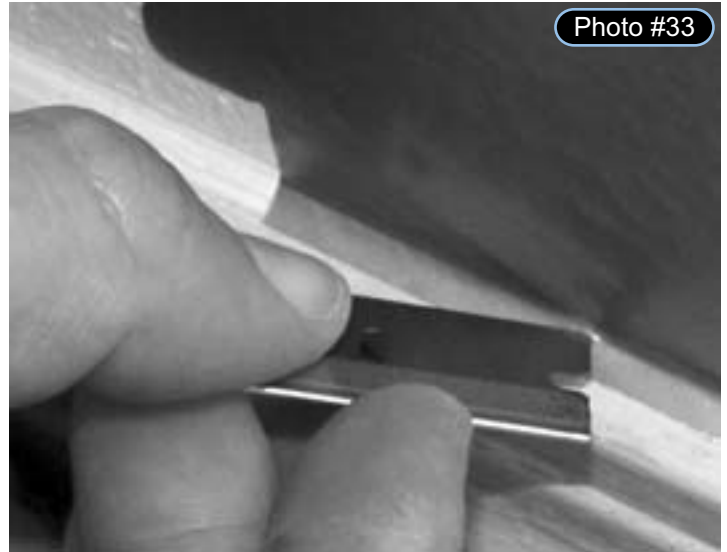

Photo #33



Photo #34

VINYL DECAL REMOVAL TIPS:

To remove the vinyl decal from your wall, simply peel up an edge and slowly peel straight back over itself at a **170-180 degree** angle, not up or straight back. Go slowly and take your time. If any adhesive residue remains on the surface once you have removed your vinyl decal, then use an adhesive remover such as GooGone to remove any film left behind. If you are removing it from a delicate surface like a wall, you can use a hair dryer (on its lowest heat setting) to soften it up and make removal easier. Do not use a heat gun as it can re-activate the adhesive and/or melt your vinyl decal making it bond to the wall even more. If the vinyl decal has been exposed to the elements for a long time (such as years of direct sunlight, bathroom steam or high humidity) the vinyl decal may be brittle and can break apart. In this case use a hair dryer or heat gun to soften the vinyl to assist with removal.